

24V DC or 115V AC Multipole

Integrated Fieldbus

Field expandable with single add-on stations

Dual spool technology

VS26G Glandless spool and sleeve for long life

VS26S Softseal spool for high flow

Wide range of accessories

UL and ATEX

Universal PNP/NPN 24V DC Multipole

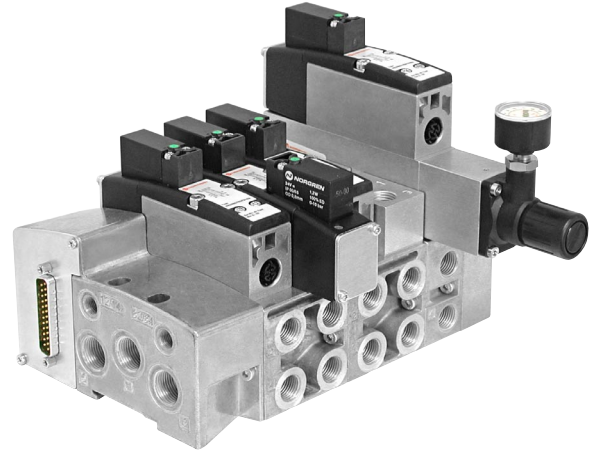

Technical data

Medium:

Compressed air, filtered to 40 µm, lubricated or non-lubricated

Operation:

VS26G: Glandless spool valve, solenoid pilot actuated

VS26S: Softseal spool valve, solenoid pilot actuated

Mounting:

Sub-base

Ports 2+4:

G1/4, NPTF1/4, PIF10 mm, PIF8 mm, PIF3/8

Operating pressure:

Maximum pressure

10 bar VS26S models and VS26G solenoid pilot actuated valves with internal pilot supply

16 bar VS26G solenoid pilot actuated valves with external pilot supply

Details of minimum and maximum pilot pressure see overleaf.

Flow characteristics:

Series	Function	C	b	A	L/min	Cv	Kv
VS26G	5/2	4,27	0,16	16,04	1000	1,02	0,87
VS26G	5/3	4,27	0,16	16,04	1000	1,02	0,87
VS26S	2x3/2	5,21	0,20	20,05	1250	1,27	1,09
VS26S	5/2	5,63	0,20	21,67	1350	1,37	1,18
VS26S	5/3	5,63	0,20	21,67	1350	1,37	1,18

Ambient temperature:

-15°C ... +50°C

Medium temperature:

-5°C ... +50°C

Consult our Technical Service for use below +2°C.

Materials

Body / sub-base: die-cast aluminium

Glandless spool & sleeve (VS26G): aluminium, hard anodised, teflon coated

Softseal spool (VS26S): aluminium with HNBR seals

Plastic parts: POM, PA, PPA

Mounting sheets / screws: steel, zinc coated

Springs: stainless steel

Sandwich plates: aluminium bar material

Regulator screws: brass

Electrical contacts: brass, tin/gold coated

PCB: glasepoxy

Ordering information

To order please use valve island configurator available at www.norgren.com
Alternatively contact Norgren for a configurator on CD or use our worksheet on page 21.

	see page
Valves	2
Accessories	6
Sub-bases and end plates	8
Sandwich plates	10
Multipole/Fieldbus	14
Add-on stations	22
Single parts	23

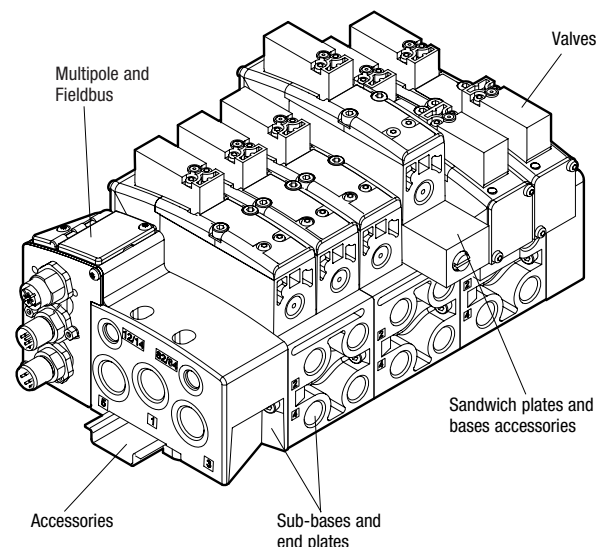



**2x3/2 Double solenoid actuated
Softseal valves (flow = 1250 L /min)**

Symbol	Model	Function 2x3/2	Actuation	Pilot supply	Pilot pressure (bar)	Operating pressure (bar)	Manual override	Voltage
	VS26SA11DF313A	NC	Sol/Spring	Internal	-	3 ... 10	Push only	24V DC 1.2W
	VS26SA11DF318A	NC	Sol/Spring	Internal	-	3 ... 10	Push only	115V AC 1.5VA
	VS26SA11DF213A	NC	Sol/Spring	Internal	-	3 ... 10	Push & turn	24V DC 1.2W
	VS26SA11DF218A	NC	Sol/Spring	Internal	-	3 ... 10	Push & turn	115V AC 1.5VA
	VS26SA11DF513A	NC	Sol/Spring	Internal	-	3 ... 10	Extended, push only	24V DC 1.2W
	VS26SA11DF518A	NC	Sol/Spring	Internal	-	3 ... 10	Extended, push only	115V AC 1.5VA
	VS26SA22DF313A	NC	Sol/Spring	External	1,7 + (0,5 x op. press.)	0 ... 10	Push only	24V DC 1.2W
	VS26SA22DF318A	NC	Sol/Spring	External	1,7 + (0,5 x op. press.)	0 ... 10	Push only	115V AC 1.5VA
	VS26SA22DF213A	NC	Sol/Spring	External	1,7 + (0,5 x op. press.)	0 ... 10	Push & turn	24V DC 1.2W
	VS26SA22DF218A	NC	Sol/Spring	External	1,7 + (0,5 x op. press.)	0 ... 10	Push & turn	115V AC 1.5VA
	VS26SA22DF513A	NC	Sol/Spring	External	1,7 + (0,5 x op. press.)	0 ... 10	Extended, push only	24V DC 1.2W
	VS26SA22DF518A	NC	Sol/Spring	External	1,7 + (0,5 x op. press.)	0 ... 10	Extended, push only	115V AC 1.5VA
	VS26SB11DF313A	NO	Sol/Spring	Internal	-	3 ... 10	Push only	24V DC 1.2W
	VS26SB11DF318A	NO	Sol/Spring	Internal	-	3 ... 10	Push only	115V AC 1.5VA
	VS26SB11DF213A	NO	Sol/Spring	Internal	-	3 ... 10	Push & turn	24V DC 1.2W
	VS26SB11DF218A	NO	Sol/Spring	Internal	-	3 ... 10	Push & turn	115V AC 1.5VA
	VS26SB11DF513A	NO	Sol/Spring	Internal	-	3 ... 10	Extended, push only	24V DC 1.2W
	VS26SB11DF518A	NO	Sol/Spring	Internal	-	3 ... 10	Extended, push only	115V AC 1.5VA
	VS26SB22DF313A	NO	Sol/Spring	External	1,7 + (0,5 x op. press.)	0 ... 10	Push only	24V DC 1.2W
	VS26SB22DF318A	NO	Sol/Spring	External	1,7 + (0,5 x op. press.)	0 ... 10	Push only	115V AC 1.5VA
	VS26SB22DF213A	NO	Sol/Spring	External	1,7 + (0,5 x op. press.)	0 ... 10	Push & turn	24V DC 1.2W
	VS26SB22DF218A	NO	Sol/Spring	External	1,7 + (0,5 x op. press.)	0 ... 10	Push & turn	115V AC 1.5VA
	VS26SB22DF513A	NO	Sol/Spring	External	1,7 + (0,5 x op. press.)	0 ... 10	Extended, push only	24V DC 1.2W
	VS26SB22DF518A	NO	Sol/Spring	External	1,7 + (0,5 x op. press.)	0 ... 10	Extended, push only	115V AC 1.5VA
	VS26SC11DF313A	NO/NC	Sol/Spring	Internal	-	3 ... 10	Push only	24V DC 1.2W
	VS26SC11DF318A	NO/NC	Sol/Spring	Internal	-	3 ... 10	Push only	115V AC 1.5VA
	VS26SC11DF213A	NO/NC	Sol/Spring	Internal	-	3 ... 10	Push & turn	24V DC 1.2W
	VS26SC11DF218A	NO/NC	Sol/Spring	Internal	-	3 ... 10	Push & turn	115V AC 1.5VA
	VS26SC11DF513A	NO/NC	Sol/Spring	Internal	-	3 ... 10	Extended, push only	24V DC 1.2W
	VS26SC11DF518A	NO/NC	Sol/Spring	Internal	-	3 ... 10	Extended, push only	115V AC 1.5VA
	VS26SC22DF313A	NO/NC	Sol/Spring	External	1,7 + (0,5 x op. press.)	0 ... 10	Push only	24V DC 1.2W
	VS26SC22DF318A	NO/NC	Sol/Spring	External	1,7 + (0,5 x op. press.)	0 ... 10	Push only	115V AC 1.5VA
	VS26SC22DF213A	NO/NC	Sol/Spring	External	1,7 + (0,5 x op. press.)	0 ... 10	Push & turn	24V DC 1.2W
	VS26SC22DF218A	NO/NC	Sol/Spring	External	1,7 + (0,5 x op. press.)	0 ... 10	Push & turn	115V AC 1.5VA
	VS26SC22DF513A	NO/NC	Sol/Spring	External	1,7 + (0,5 x op. press.)	0 ... 10	Extended, push only	24V DC 1.2W
	VS26SC22DF518A	NO/NC	Sol/Spring	External	1,7 + (0,5 x op. press.)	0 ... 10	Extended, push only	115V AC 1.5VA

Valve dimensions see page 7

Valve functions designations:
NO = Normally open
NC = Normally closed



5/2 Single and double solenoid actuated Glandless valves (flow = 1000 L/min)

Symbol	Model	Function	Actuation	Pilot supply	Pilot pressure (bar)	Operating pressure (bar)	Manual override	Voltage
	VS26G511DF313A	5/2	Sol/Sol	Internal	-	2 ... 10	Push only	24V DC 1.2W
	VS26G511DF318A	5/2	Sol/Sol	Internal	-	2 ... 10	Push only	115V AC 1.5VA
	VS26G511DF213A	5/2	Sol/Sol	Internal	-	2 ... 10	Push & turn	24V DC 1.2W
	VS26G511DF218A	5/2	Sol/Sol	Internal	-	2 ... 10	Push & turn	115V AC 1.5VA
	VS26G511DF513A	5/2	Sol/Sol	Internal	-	2 ... 10	Extended, push only	24V DC 1.2W
	VS26G522DF313A	5/2	Sol/Sol	External	2 ... 10	-0,9 ... 16	Push only	24V DC 1.2W
	VS26G522DF318A	5/2	Sol/Sol	External	2 ... 10	-0,9 ... 16	Push only	115V AC 1.5VA
	VS26G522DF213A	5/2	Sol/Sol	External	2 ... 10	-0,9 ... 16	Push & turn	24V DC 1.2W
	VS26G522DF218A	5/2	Sol/Sol	External	2 ... 10	-0,9 ... 16	Push & turn	115V AC 1.5VA
	VS26G522DF513A	5/2	Sol/Sol	External	2 ... 10	-0,9 ... 16	Extended, push only	24V DC 1.2W
	VS26G591DF313A	5/2	Sol (Priority)/Sol	Internal	-	2 ... 10	Push only	24V DC 1.2W
	VS26G591DF318A	5/2	Sol (Priority)/Sol	Internal	-	2 ... 10	Push only	115V AC 1.5VA
	VS26G591DF213A	5/2	Sol (Priority)/Sol	Internal	-	2 ... 10	Push & turn	24V DC 1.2W
	VS26G591DF218A	5/2	Sol (Priority)/Sol	Internal	-	2 ... 10	Push & turn	115V AC 1.5VA
	VS26G591DF513A	5/2	Sol (Priority)/Sol	Internal	-	2 ... 10	Extended, push only	24V DC 1.2W
	VS26G592DF313A	5/2	Sol (Priority)/Sol	External	2 ... 10	-0,9 ... 16	Push only	24V DC 1.2W
	VS26G592DF318A	5/2	Sol (Priority)/Sol	External	2 ... 10	-0,9 ... 16	Push only	115V AC 1.5VA
	VS26G592DF213A	5/2	Sol (Priority)/Sol	External	2 ... 10	-0,9 ... 16	Push & turn	24V DC 1.2W
	VS26G592DF218A	5/2	Sol (Priority)/Sol	External	2 ... 10	-0,9 ... 16	Push & turn	115V AC 1.5VA
	VS26G592DF513A	5/2	Sol (Priority)/Sol	External	2 ... 10	-0,9 ... 16	Extended, push only	24V DC 1.2W
	VS26G517DF313A	5/2	Sol/Spring	Internal	-	1,6 ... 10	Push only	24V DC 1.2W
	VS26G517DF318A	5/2	Sol/Spring	Internal	-	1,6 ... 10	Push only	115V AC 1.5VA
	VS26G517DF213A	5/2	Sol/Spring	Internal	-	1,6 ... 10	Push & turn	24V DC 1.2W
	VS26G517DF218A	5/2	Sol/Spring	Internal	-	1,6 ... 10	Push & turn	115V AC 1.5VA
	VS26G517DF513A	5/2	Sol/Spring	Internal	-	1,6 ... 10	Extended, push only	24V DC 1.2W
	VS26G527DF313A	5/2	Sol/Spring	External	1,6 ... 10	-0,9 ... 16	Push only	24V DC 1.2W
	VS26G527DF318A	5/2	Sol/Spring	External	1,6 ... 10	-0,9 ... 16	Push only	115V AC 1.5VA
	VS26G527DF213A	5/2	Sol/Spring	External	1,6 ... 10	-0,9 ... 16	Push & turn	24V DC 1.2W
	VS26G527DF218A	5/2	Sol/Spring	External	1,6 ... 10	-0,9 ... 16	Push & turn	115V AC 1.5VA
	VS26G527DF513A	5/2	Sol/Spring	External	1,6 ... 10	-0,9 ... 16	Extended, push only	24V DC 1.2W
	VS26G527DF518A	5/2	Sol/Spring	External	1,6 ... 10	-0,9 ... 16	Extended, push only	115V AC 1.5VA

5/2 Single and double solenoid actuated Softseal valves (flow = 1350 L/min)

Symbol	Model	Function	Actuation	Pilot supply	Pilot pressure (bar)	Operating pressure (bar)	Manual override	Voltage
	VS26S511DF313A	5/2	Sol/Sol	Internal	-	2 ... 10	Push only	24V DC 1.2W
	VS26S511DF318A	5/2	Sol/Sol	Internal	-	2 ... 10	Push only	115V AC 1.5VA
	VS26S511DF213A	5/2	Sol/Sol	Internal	-	2 ... 10	Push & turn	24V DC 1.2W
	VS26S511DF218A	5/2	Sol/Sol	Internal	-	2 ... 10	Push & turn	115V AC 1.5VA
	VS26S511DF513A	5/2	Sol/Sol	Internal	-	2 ... 10	Extended, push only	24V DC 1.2W
	VS26S522DF313A	5/2	Sol/Sol	External	2 ... 10	-0,9 ... 10	Push only	24V DC 1.2W
	VS26S522DF318A	5/2	Sol/Sol	External	2 ... 10	-0,9 ... 10	Push only	115V AC 1.5VA
	VS26S522DF213A	5/2	Sol/Sol	External	2 ... 10	-0,9 ... 10	Push & turn	24V DC 1.2W
	VS26S522DF218A	5/2	Sol/Sol	External	2 ... 10	-0,9 ... 10	Push & turn	115V AC 1.5VA
	VS26S522DF513A	5/2	Sol/Sol	External	2 ... 10	-0,9 ... 10	Extended, push only	24V DC 1.2W
	VS26S517DF313A	5/2	Sol/Spring	Internal	-	2 ... 10	Push only	24V DC 1.2W
	VS26S517DF318A	5/2	Sol/Spring	Internal	-	2 ... 10	Push only	115V AC 1.5VA
	VS26S517DF213A	5/2	Sol/Spring	Internal	-	2 ... 10	Push & turn	24V DC 1.2W
	VS26S517DF218A	5/2	Sol/Spring	Internal	-	2 ... 10	Push & turn	115V AC 1.5VA
	VS26S517DF513A	5/2	Sol/Spring	Internal	-	2 ... 10	Extended, push only	24V DC 1.2W
	VS26S527DF313A	5/2	Sol/Spring	External	2 ... 10	-0,9 ... 10	Push only	24V DC 1.2W
	VS26S527DF318A	5/2	Sol/Spring	External	2 ... 10	-0,9 ... 10	Push only	115V AC 1.5VA
	VS26S527DF213A	5/2	Sol/Spring	External	2 ... 10	-0,9 ... 10	Push & turn	24V DC 1.2W
	VS26S527DF218A	5/2	Sol/Spring	External	2 ... 10	-0,9 ... 10	Push & turn	115V AC 1.5VA
	VS26S527DF513A	5/2	Sol/Spring	External	2 ... 10	-0,9 ... 10	Extended, push only	24V DC 1.2W
	VS26S527DF518A	5/2	Sol/Spring	External	2 ... 10	-0,9 ... 10	Extended, push only	115V AC 1.5VA

Valve dimensions see page 7



**5/3 Double solenoid actuated
Glandless valves (flow = 1000 L/min)**

Symbol	Model	Function 5/3	Action	Pilot supply	Pilot pressure (bar)	Operating pressure (bar)	Manual override	Voltage
	VS26G611DF213A	APB	Sol/Sol	Internal	-	2 ... 10	Push & turn	24V DC 1.2W
	VS26G611DF218A	APB	Sol/Sol	Internal	-	2 ... 10	Push & turn	115V AC 1.5VA
	VS26G611DF313A	APB	Sol/Sol	Internal	-	2 ... 10	Push only	24V DC 1.2W
	VS26G611DF318A	APB	Sol/Sol	Internal	-	2 ... 10	Push only	115V AC 1.5VA
	VS26G611DF513A	APB	Sol/Sol	Internal	-	2 ... 10	Extended, push only	24V DC 1.2W
	VS26G611DF518A	APB	Sol/Sol	Internal	-	2 ... 10	Extended, push only	115V AC 1.5VA
	VS26G622DF213A	APB	Sol/Sol	External	2 ... 10	-0,9 ... 16	Push & turn	24V DC 1.2W
	VS26G622DF218A	APB	Sol/Sol	External	2 ... 10	-0,9 ... 16	Push & turn	115V AC 1.5VA
	VS26G622DF313A	APB	Sol/Sol	External	2 ... 10	-0,9 ... 16	Push only	24V DC 1.2W
	VS26G622DF318A	APB	Sol/Sol	External	2 ... 10	-0,9 ... 16	Push only	115V AC 1.5VA
	VS26G622DF513A	APB	Sol/Sol	External	2 ... 10	-0,9 ... 16	Extended, push only	24V DC 1.2W
	VS26G622DF518A	APB	Sol/Sol	External	2 ... 10	-0,9 ... 16	Extended, push only	115V AC 1.5VA
	VS26G711DF213A	COE	Sol/Sol	Internal	-	2 ... 10	Push & turn	24V DC 1.2W
	VS26G711DF218A	COE	Sol/Sol	Internal	-	2 ... 10	Push & turn	115V AC 1.5VA
	VS26G711DF313A	COE	Sol/Sol	Internal	-	2 ... 10	Push only	24V DC 1.2W
	VS26G711DF318A	COE	Sol/Sol	Internal	-	2 ... 10	Push only	115V AC 1.5VA
	VS26G711DF513A	COE	Sol/Sol	Internal	-	2 ... 10	Extended, push only	24V DC 1.2W
	VS26G711DF518A	COE	Sol/Sol	Internal	-	2 ... 10	Extended, push only	115V AC 1.5VA
	VS26G722DF213A	COE	Sol/Sol	External	2 ... 10	-0,9 ... 16	Push & turn	24V DC 1.2W
	VS26G722DF218A	COE	Sol/Sol	External	2 ... 10	-0,9 ... 16	Push & turn	115V AC 1.5VA
	VS26G722DF313A	COE	Sol/Sol	External	2 ... 10	-0,9 ... 16	Push only	24V DC 1.2W
	VS26G722DF318A	COE	Sol/Sol	External	2 ... 10	-0,9 ... 16	Push only	115V AC 1.5VA
	VS26G722DF513A	COE	Sol/Sol	External	2 ... 10	-0,9 ... 16	Extended, push only	24V DC 1.2W
	VS26G722DF518A	COE	Sol/Sol	External	2 ... 10	-0,9 ... 16	Extended, push only	115V AC 1.5VA

**5/3 Double solenoid actuated
Softseal valves (flow = 1350 L/min)**

Symbol	Model	Function 5/3	Action	Pilot supply	Pilot pressure (bar)	Operating pressure (bar)	Manual override	Voltage
	VS26S611DF213A	APB	Sol/Sol	Internal	-	2,5 ... 10	Push & turn	24V DC 1.2W
	VS26S611DF218A	APB	Sol/Sol	Internal	-	2,5 ... 10	Push & turn	115V AC 1.5VA
	VS26S611DF313A	APB	Sol/Sol	Internal	-	2,5 ... 10	Push only	24V DC 1.2W
	VS26S611DF318A	APB	Sol/Sol	Internal	-	2,5 ... 10	Push only	115V AC 1.5VA
	VS26S611DF513A	APB	Sol/Sol	Internal	-	2,5 ... 10	Extended, push only	24V DC 1.2W
	VS26S611DF518A	APB	Sol/Sol	Internal	-	2,5 ... 10	Extended, push only	115V AC 1.5VA
	VS26S622DF213A	APB	Sol/Sol	External	2,5 ... 10	-0,9 ... 10	Push & turn	24V DC 1.2W
	VS26S622DF218A	APB	Sol/Sol	External	2,5 ... 10	-0,9 ... 10	Push & turn	115V AC 1.5VA
	VS26S622DF313A	APB	Sol/Sol	External	2,5 ... 10	-0,9 ... 10	Push only	24V DC 1.2W
	VS26S622DF318A	APB	Sol/Sol	External	2,5 ... 10	-0,9 ... 10	Push only	115V AC 1.5VA
	VS26S622DF513A	APB	Sol/Sol	External	2,5 ... 10	-0,9 ... 10	Extended, push only	24V DC 1.2W
	VS26S622DF518A	APB	Sol/Sol	External	2,5 ... 10	-0,9 ... 10	Extended, push only	115V AC 1.5VA
	VS26S711DF213A	COE	Sol/Sol	Internal	-	2,5 ... 10	Push & turn	24V DC 1.2W
	VS26S711DF218A	COE	Sol/Sol	Internal	-	2,5 ... 10	Push & turn	115V AC 1.5VA
	VS26S711DF313A	COE	Sol/Sol	Internal	-	2,5 ... 10	Push only	24V DC 1.2W
	VS26S711DF318A	COE	Sol/Sol	Internal	-	2,5 ... 10	Push only	115V AC 1.5VA
	VS26S711DF513A	COE	Sol/Sol	Internal	-	2,5 ... 10	Extended, push only	24V DC 1.2W
	VS26S711DF518A	COE	Sol/Sol	Internal	-	2,5 ... 10	Extended, push only	115V AC 1.5VA
	VS26S722DF213A	COE	Sol/Sol	External	2,5 ... 10	-0,9 ... 10	Push & turn	24V DC 1.2W
	VS26S722DF218A	COE	Sol/Sol	External	2,5 ... 10	-0,9 ... 10	Push & turn	115V AC 1.5VA
	VS26S722DF313A	COE	Sol/Sol	External	2,5 ... 10	-0,9 ... 10	Push only	24V DC 1.2W
	VS26S722DF318A	COE	Sol/Sol	External	2,5 ... 10	-0,9 ... 10	Push only	115V AC 1.5VA
	VS26S722DF513A	COE	Sol/Sol	External	2,5 ... 10	-0,9 ... 10	Extended, push only	24V DC 1.2W
	VS26S722DF518A	COE	Sol/Sol	External	2,5 ... 10	-0,9 ... 10	Extended, push only	115V AC 1.5VA

Valve dimensions see page 7

Valve functions designations:
APB = All ports blocked
COE = Centre open exhaust



Valve part no. breakdown

VS26***DF***A

Spool technology	Substitute
Glandless spool & sleeve	G
Softseal spool	S

Guiding systems	Substitute
2x3/2 Normally closed ¹⁾	A
2x3/2 Normally open ¹⁾	B
2x3/2 Normally open/Normally closed ¹⁾	C
5/2	5
5/3 All ports blocked	6
5/3 Centre open exhaust	7

¹⁾ Available with softseal spool only

Voltage	Substitute
24V DC 1.2W	13
115V AC 1.5VA	18

Manual override	Substitute
Push & turn	2
Push only	3
Extended, push only	5

Actuation/Pilot supply	Substitute
Solenoid/Spring	
Internal pilot supply	17
Solenoid/Spring	
External pilot supply	27
Solenoid/Solenoid	
Internal pilot supply	11
Solenoid/Solenoid	
External pilot supply	22
Solenoid priority side 14/Solenoid (5/2 only)	
Internal pilot supply ²⁾	91
Solenoid priority side 14/Solenoid (5/2 only)	
External pilot supply ²⁾	92

²⁾ Available with glandless spool & sleeve only

Electrical details for solenoid operators

Voltage tolerances	(24V DC) +/- 10%
Voltage tolerances	(115V AC) -10%/+15%
Rating	100 % Continuous duty
Inlet orifice	0.8 mm
Indication	LED green
Surge suppression	Transil diode
Materials	PPS (body), Viton and NBR (seal)

Protection classification (IP code)

All VS26 valve islands fulfil IP65 and NEMA4 ratings.

PELV (Electrical protection class III)

All VS26 24V DC products are designed to be used with a protective extra low voltage (PELV) power supply.

UL approval

UL approval for Multipole and Fieldbus valve islands ongoing. Please contact customer service for detailed information.

ATEX

ATEX category 3 approval for 24V DC Multipole and Fieldbus valve islands ongoing. Please contact customer service for detailed information.

Warning

These products are intended for use in industrial compressed air systems only. Do not use these products where pressures and temperatures can exceed those listed under 'Technical Data'.

Before using these products with fluids other than those specified, for non-industrial applications, life-support systems, or other applications not within published specifications, consult NORGREN. Through misuse, age, or malfunction, components used in fluid power systems can fail in various modes.





The system designer is warned to consider the failure modes of all component parts used in fluid power systems and to provide adequate safeguards to prevent personal injury or damage to equipment in the event of such failure.

System designers must provide a warning to end users in the system instructional manual if protection against a failure mode cannot be adequately provided.

System designers and end users are cautioned to review specific warnings found in instruction sheets packed and shipped with these products.

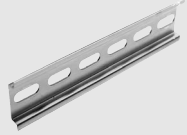



Accessories





DIN EN 50 022 rail (1 metre) 	DIN-rail mounting kit 	Blanking disc to modular sub-base 	Manual override set-up kit 	Spare valve identification labels ¹⁾ 
V10009-C00 (35 x 7,5 mm) V10592-C01 (35 x 15 mm)	V70531-KA0	V70522-K00 (Ports 1, 3, 5) V70523-K00 (Ports 12/14)	VS2672906-KG00	VS2672905-KG00 (10 pcs)

¹⁾ When purchasing assembled valve islands from Norgren, valve identification labels are already included.

Base accessories

Intermediate supply/exhaust module 	Blanking plate 
Page 12 VS2672902-BG00 (G1/4) VS2672902-RG00 (NPTF1/4)	Page 12 VS2672904-KG00

Sandwich plates

Single pressure regulator plate 	Double pressure regulator plate 	Flow regulator plate 	Single valve shut-off plate 
Page 10 VS2672900-KG10 (port 1) VS2672900-KG20 (port 2) VS2672900-KG30 (port 4)	Page 10 VS2672900-KG40 (port 2+4)	Page 11 VS2672901-KG00	Page 12 VS2672903-KG00

Sub-bases and end plates

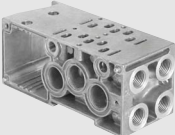
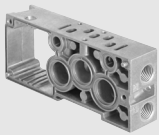
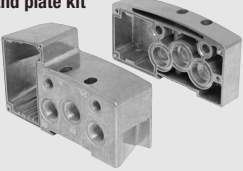
Single station sub-base 	Double station modular sub-base 	Single station modular sub-base 	End plate kit 
Page 8	Page 9 for dimensions. Page 23 for ordering information.		



Valve dimensions

VS26*5*7DF*1*A models
5/2 Single solenoid pilot valve
Mechanical spring return

VS26**DF*1*A models**
2x3/2, 5/2 and 5/3 Double solenoid pilot valve

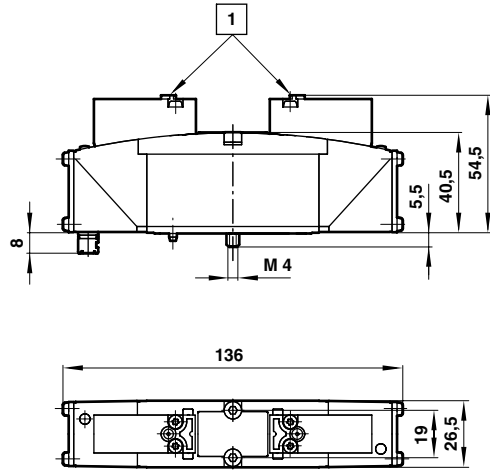
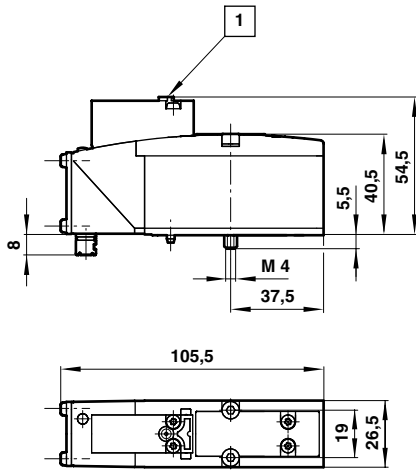

1 Manual override



Single station sub-base

Model	Description	Ports 1, 3 & 5	Ports 12/14 & 82/84	Ports 2 & 4	Connector type
VS2672510-BG00	Single station sub-base for 24V DC	G1/4	G1/8	G1/4	M12
VS2672510-RG00	Single station sub-base for 24V DC	NPTF1/4	NPTF1/8	NPTF1/4	M12
VS2672511-RG00	Single station sub-base for 24V DC and 115V AC	NPTF1/4	NPTF1/8	NPTF1/4	NPTF1/2 conduit

Connector type: NPTF1/2 conduit with flying leads

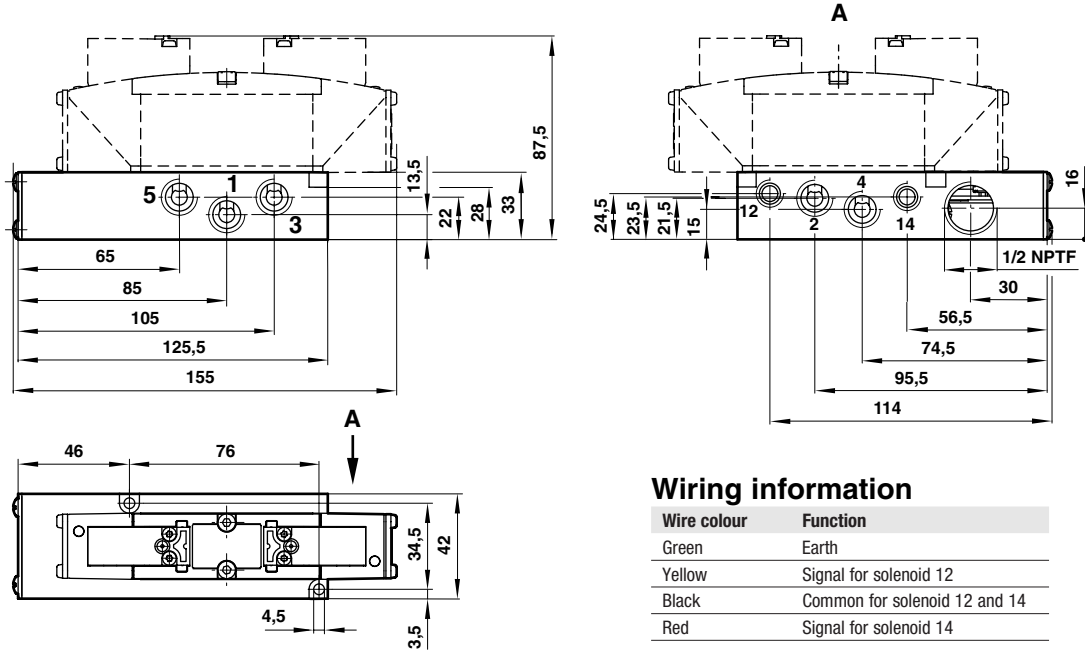

Wiring information

Wire colour	Function
Green	Earth
Yellow	Signal for solenoid 12
Black	Common for solenoid 12 and 14
Red	Signal for solenoid 14

Connector type: M12

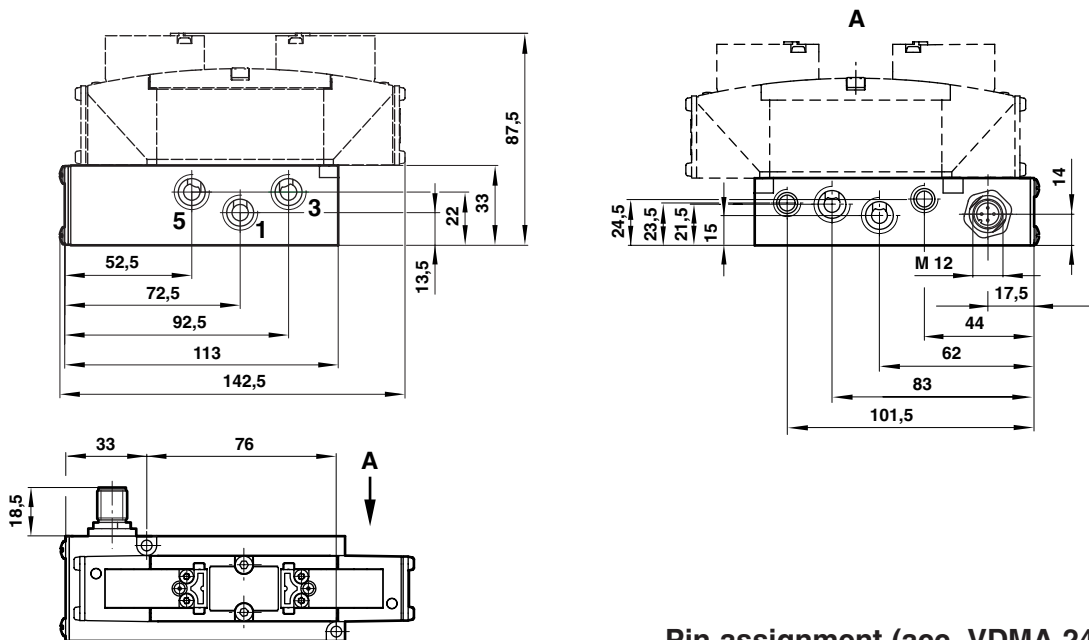

Pin assignment (acc. VDMA 24571)

Pin no.	Function
1	not used
2	Signal for solenoid 12
3	Common for solenoid 12 and 14
4	Signal for solenoid 14





Valve islands dimensions

See page 23 for sub-base and end plate kit ordering information.

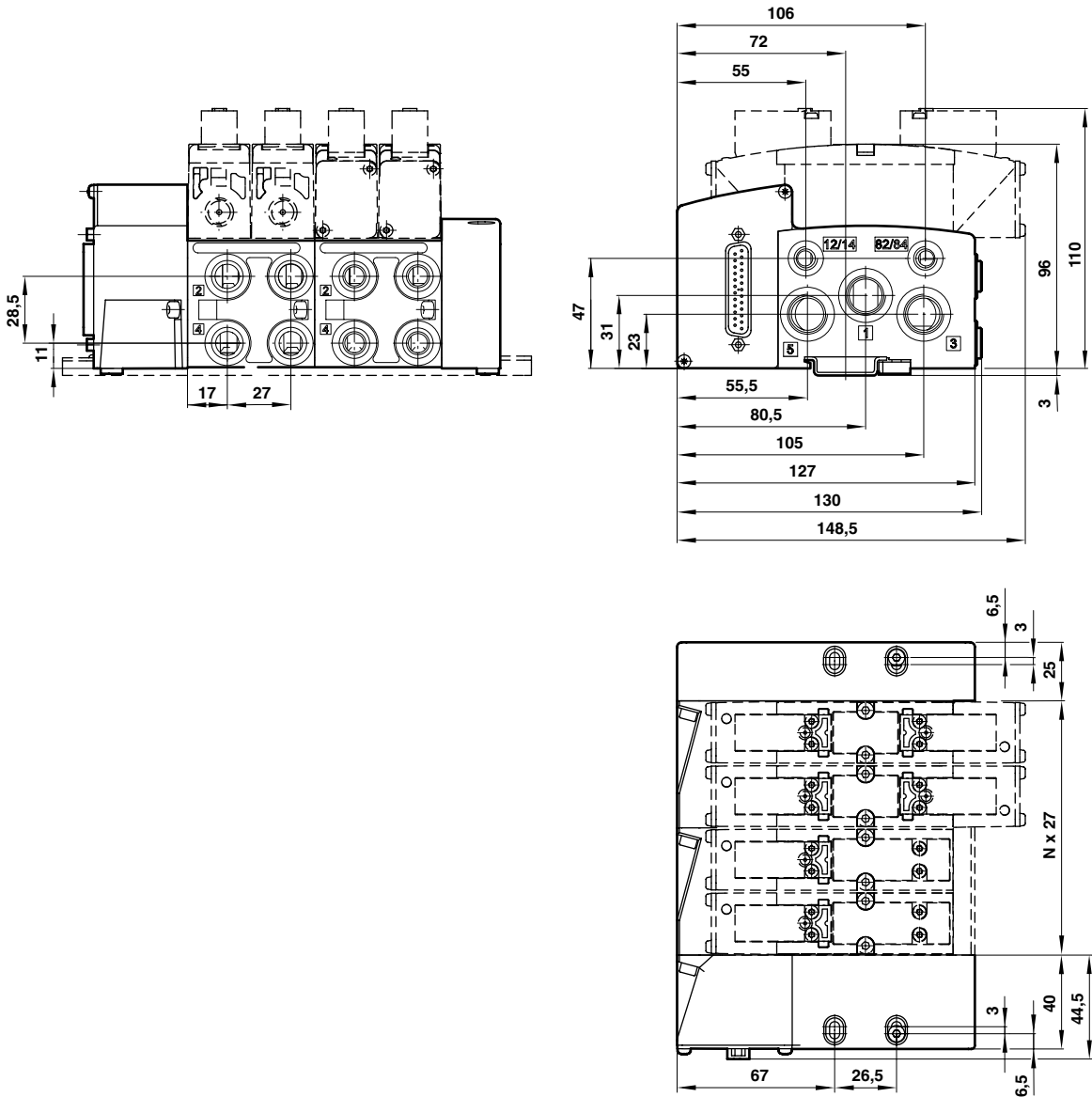

Electrical connection	Min. no. of valve stations	Max. no. of valve stations	For details see page
Multipole	2	16	14
AS-Interface	2	8	17
Other Fieldbus protocols	4	16	17

N Number of station



Sandwich plates

Pressure regulator sandwich plates

Symbol	Model	Description	Symbol	Model	Description
	VS2672900-KG10	Regulation of port 1, regulator on side 12		VS2672900-KG30	Regulation of port 4, regulator on side 14
	VS2672900-KG20	Regulation of port 2, regulator on side 12		VS2672900-KG40	Regulation of port 2+4

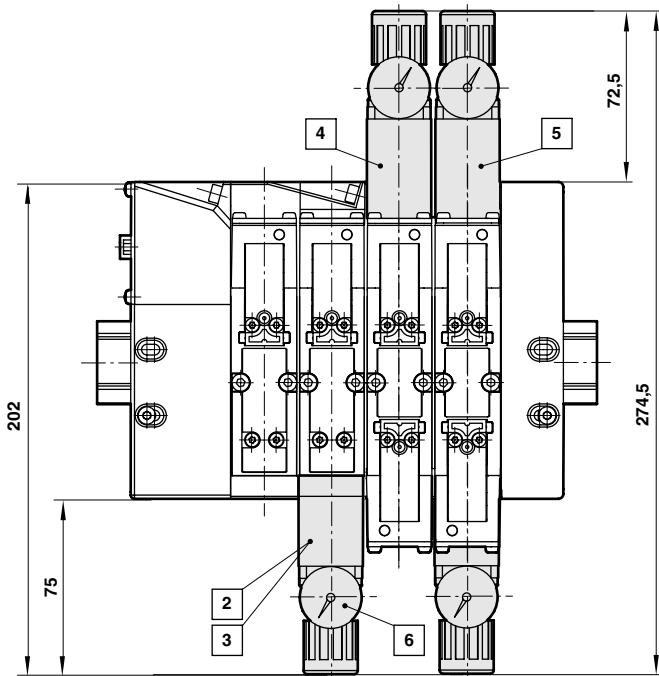
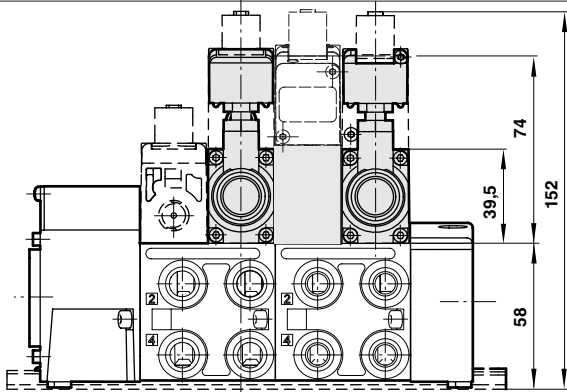

Flow characteristics for pressure regulator plates

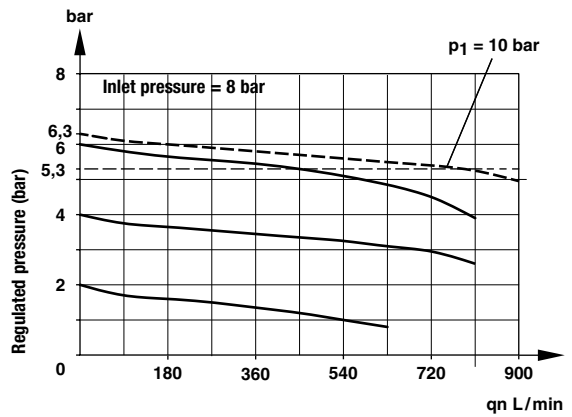

Hysteresis

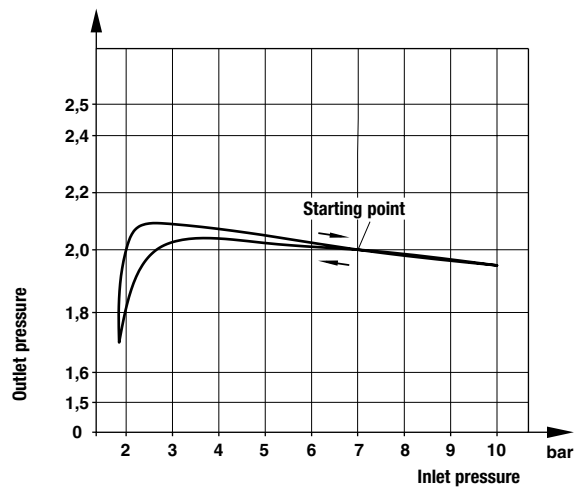

Spare part number for gauge = V70534-500

- 2** Regulation of port 1
- 3** Regulation of port 2
- 4** Regulation of port 4
- 5** Regulation of port 2+4
- 6** Gauge



Sandwich plates

Flow regulator sandwich plate

Symbol	Model	Description
	VS2672901-KG00	Flow regulator supplied with gasket, dual regulation of exhaust ports 3 and 5

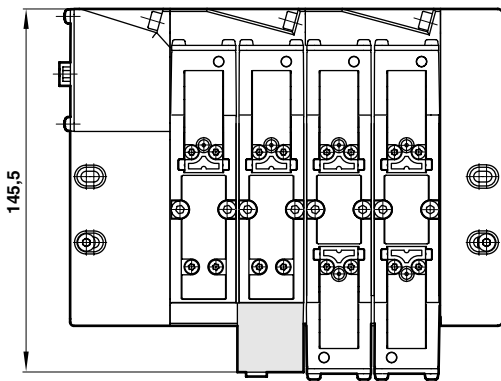
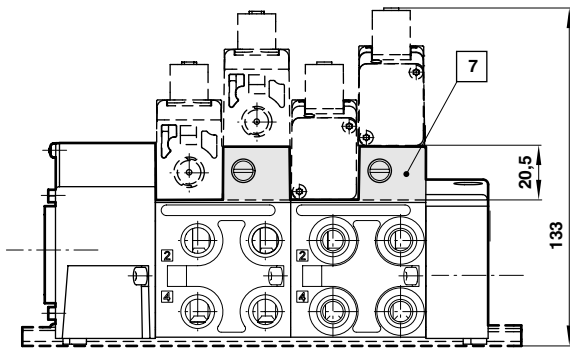

7 Flow regulator plate

Flow characteristics Dual regulation of exhaust ports 3 and 5

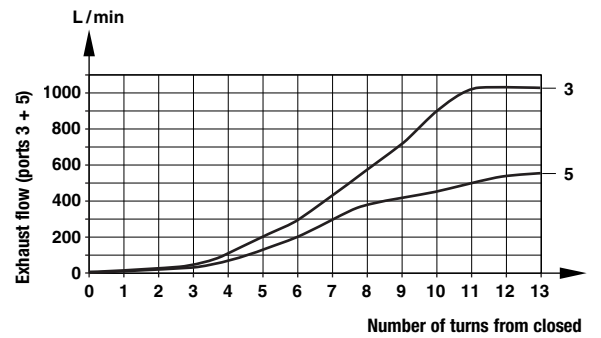

**Flow: port 1-2 and 1-4: remains unchanged.
Flow measured at 6 bar inlet, pressure drop 1 bar**



Sandwich plates

Single valve shut-off plate

Symbol	Model	Description
	VS2672903-KG00	Single valve shut-off plate supplied with gasket

Allows individual exchange of valve while valve island is pressurised by port 1.

Flow restricted to max. 550 L/min.

Base accessories

Model	Description
VS2672902-BG00	Intermediate supply/exhaust module, port size G1/4 ¹⁾
VS2672902-RG00	Intermediate supply/exhaust module, port size NPTF1/4 ¹⁾
VS2672902-KG00	Blanking plate for blocking of unused stations (supplied with gasket)

¹⁾ for use see page 13

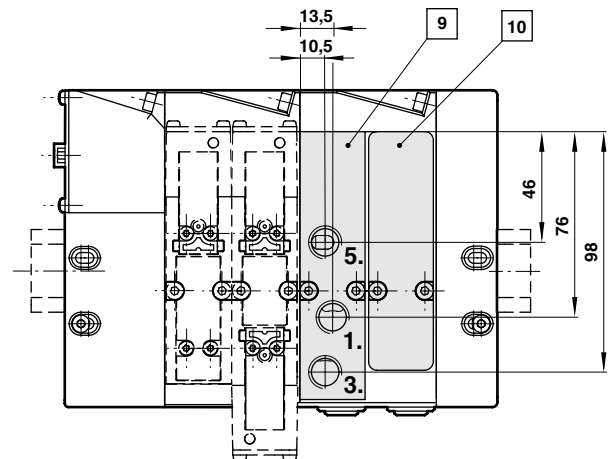
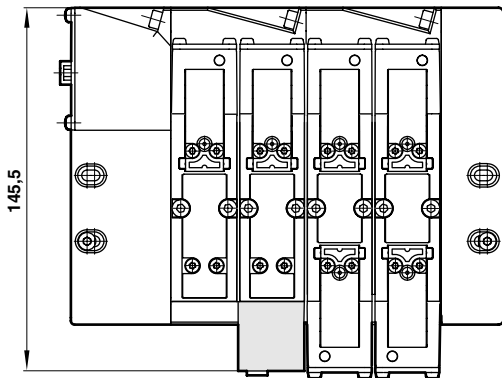
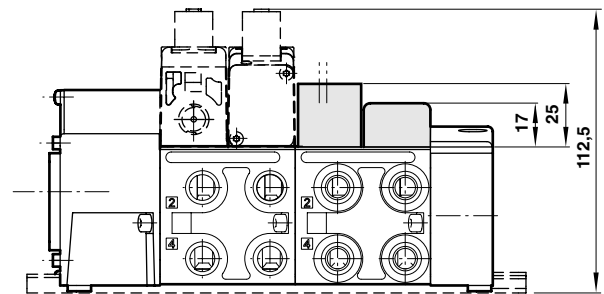
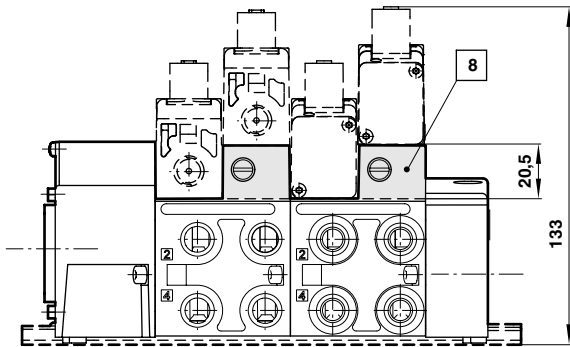

- 8** Single valve shut-off plate
- 9** Intermediate supply/exhaust module
- 10** Blanking plate



Multi pressure configurations

A

Blanking disc	Type
V70522-K00	Suitable for ports 1, 3 or 5

B

Intermediate supply/exhaust module	Type
VS2672902-BG00A	G1/4
VS2672902-RG00A	NPTF1/4

Dual pressure

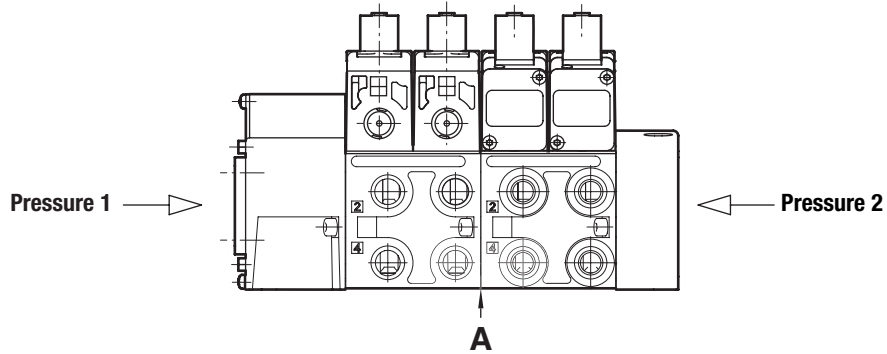

Multi pressure

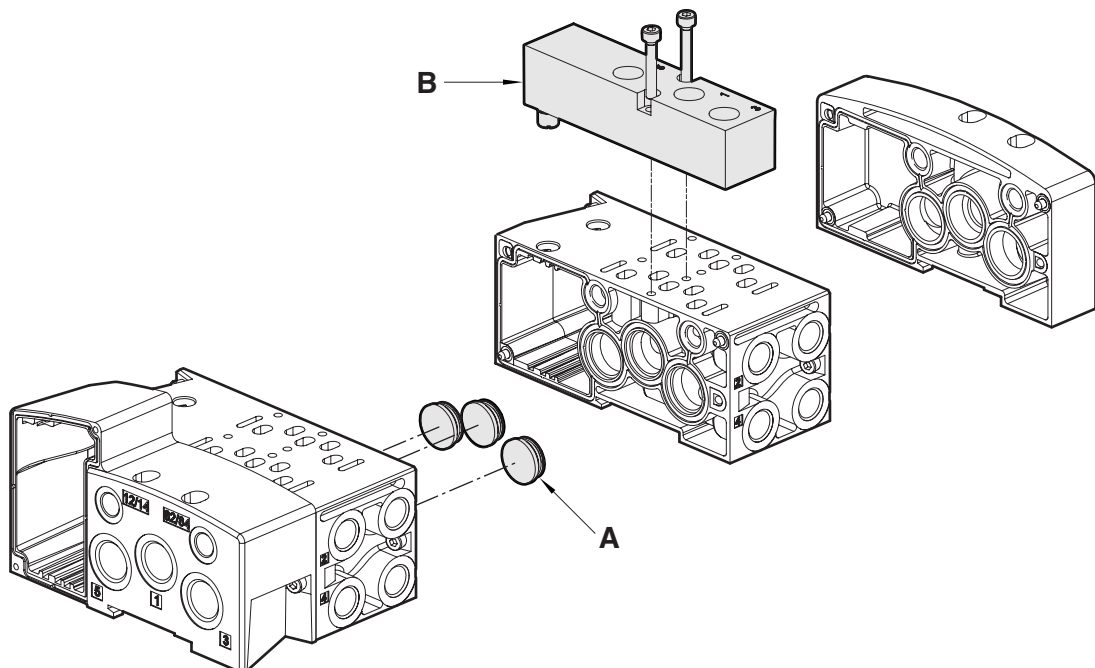
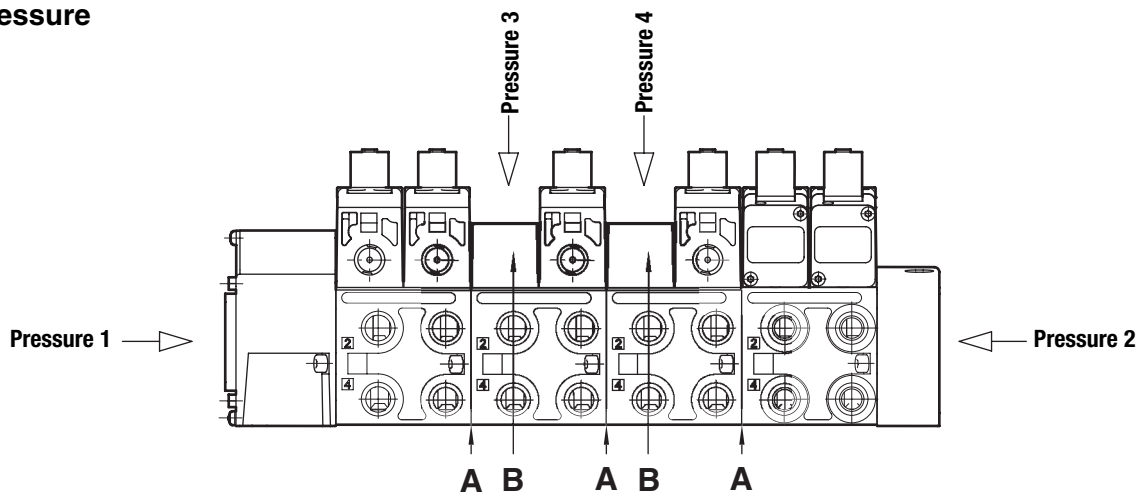



Multipole options

Connector type	Voltage	No. of stations	Max. no. coils
D-Sub 9-pin	24V DC	02/03/04	8
D-Sub 15-pin	24V DC	02/03/04/05/06/07	14
D-Sub 25-pin	24V DC	02/03/04/05/06/07/08/09/10/11/12	24
D-Sub 44-pin	24V DC	08/09/10/11/12/13/14/15/16	32
NPTF1 Conduit entry with terminals	115V AC, 24V DC	02/03/04/05/06/07/08/09/10/11/12	24

For details on single parts see pages 22-25

D-Sub 9-pin

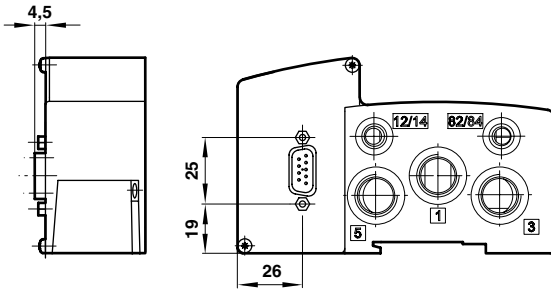

D-Sub 15-pin

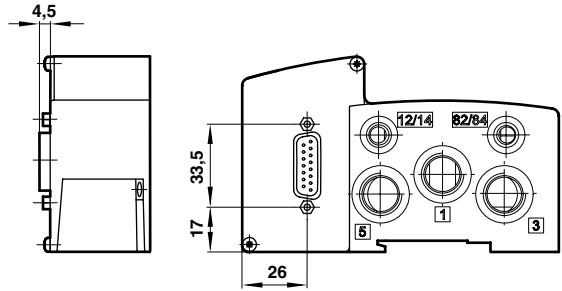

D-Sub 25- / 44-pin

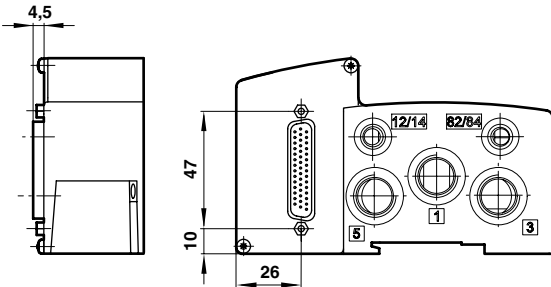

NPTF1 Conduit entry with terminals

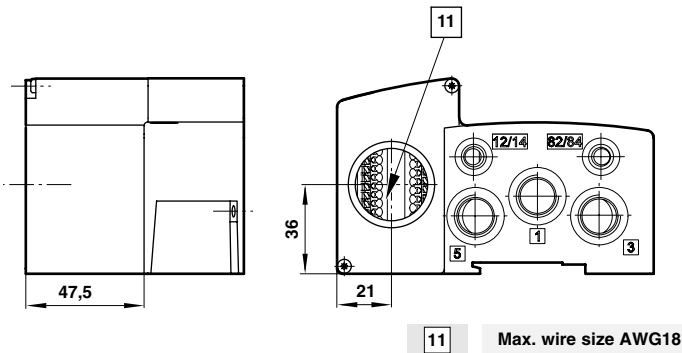



Multipole accessories

D-Sub connector 9-pin IP65 ¹⁾



D-Sub connector 15-pin IP65 ¹⁾



D-Sub connector 25-pin IP65 ¹⁾



D-Sub connector 44-pin IP65 ¹⁾



VS2672910-KG00	1m	VS2672915-KG00	1m	V11569-E01	1m	V11570-E01	1m
VS2672911-KG00	3m	VS2672916-KG00	3m	V11569-E03	3m	V11570-E03	3m
VS2672912-KG00	5m	VS2672917-KG00	5m	V11569-E05	5m	V11570-E05	5m

¹⁾ Required for ATEX

D-Sub connector 9-pin ¹⁾

Pin no.	Wire colour	Socket	Pilot	Station
1	White	Solenoid 1-a	14	1
2	Brown	Solenoid 2-a	14	2
3	Green	Solenoid 3-a	14	3
4	Yellow	Solenoid 4-a	14	4
5	Grey	Solenoid 1-b	12	1
6	Pink	Solenoid 2-b	12	2
7	Blue	Solenoid 3-b	12	3
8	Red	Solenoid 4-b	12	4
9	Black	Common	-	-

D-Sub connector 25-pin ¹⁾

Pin no.	Wire colour	Socket	Pilot	Station
1	White	Solenoid 1-a	14	1
2	Brown	Solenoid 2-a	14	2
3	Green	Solenoid 3-a	14	3
4	Yellow	Solenoid 4-a	14	4
5	Grey	Solenoid 5-a	14	5
6	Pink	Solenoid 6-a	14	6
7	Blue	Solenoid 7-a	14	7
8	Red	Solenoid 8-a	14	8
9	Black	Solenoid 9-a	14	9
10	Violet	Solenoid 10-a	14	10
11	Grey/Pink	Solenoid 11-a	14	11
12	Red/Blue	Solenoid 12-a	14	12
13	White/Green	Common	-	-
14	Brown/Green	Solenoid 1-b	12	1
15	White/Yellow	Solenoid 2-b	12	2
16	Yellow/Brown	Solenoid 3-b	12	3
17	White/Grey	Solenoid 4-b	12	4
18	Grey/Brown	Solenoid 5-b	12	5
19	White/Pink	Solenoid 6-b	12	6
20	Pink/Brown	Solenoid 7-b	12	7
21	White/Blue	Solenoid 8-b	12	8
22	Brown/Blue	Solenoid 9-b	12	9
23	White/Red	Solenoid 10-b	12	10
24	Brown/Red	Solenoid 11-b	12	11
25	White/Black	Solenoid 12-b	12	12

D-Sub connector 15-pin ¹⁾

Pin no.	Wire colour	Socket	Pilot	Station
1	White	Solenoid 1-a	14	1
2	Brown	Solenoid 2-a	14	2
3	Green	Solenoid 3-a	14	3
4	Yellow	Solenoid 4-a	14	4
5	Grey	Solenoid 5-a	14	5
6	Pink	Solenoid 6-a	14	6
7	Blue	Solenoid 7-a	14	7
8	Red	Solenoid 1-b	12	1
9	Black	Solenoid 2-b	12	2
10	Violet	Solenoid 3-b	12	3
11	Grey/Pink	Solenoid 4-b	12	4
12	Red/Blue	Solenoid 5-b	12	5
13	White/Green	Solenoid 6-b	12	6
14	Brown/Green	Solenoid 7-b	12	7
15	White/Yellow	Common	-	-

¹⁾ According to DIN 47100



D-Sub connector 44-pin ¹⁾

Pin no.	Wire colour	Socket	Pilot	Station
1	White	Solenoid 1-a	14	1
2	Brown	Solenoid 2-a	14	2
3	Green	Solenoid 3-a	14	3
4	Yellow	Solenoid 4-a	14	4
5	Grey	Solenoid 5-a	14	5
6	Pink	Solenoid 6-a	14	6
7	Blue	Solenoid 7-a	14	7
8	Red	Solenoid 8-a	14	8
9	Black	Solenoid 9-a	14	9
10	Violet	Solenoid 10-a	14	10
11	Grey/Pink	Solenoid 11-a	14	11
12	Red/Blue	Solenoid 12-a	14	12
13	White/Green	Solenoid 13-a	14	13
14	Brown/Green	Solenoid 14-a	14	14
15	White/Yellow	Solenoid 15-a	14	15
16	Yellow/Brown	Solenoid 1-b	12	1
17	White/Grey	Solenoid 2-b	12	2
18	Grey/Brown	Solenoid 3-b	12	3
19	White/Pink	Solenoid 4-b	12	4
20	Pink/Brown	Solenoid 5-b	12	5
21	White/Blue	Solenoid 6-b	12	6
22	Brown/Blue	Solenoid 7-b	12	7
23	White/Red	Solenoid 8-b	12	8
24	Brown/Red	Solenoid 9-b	12	9
25	White/Black	Solenoid 10-b	12	10
26	Brown/Black	Solenoid 11-b	12	11
27	Grey/Green	Solenoid 12-b	12	12
28	Yellow/Grey	Solenoid 13-b	12	13
29	Pink/Green	Solenoid 14-b	12	14
30	Yellow/Pink	Solenoid 15-b	12	15
31	Green/Blue	Solenoid 16-a	14	16
32	Yellow/Blue	Solenoid 16-b	12	16
33	Green/Red	NOT USED	-	-
34	Yellow/Red	NOT USED	-	-
35	Green/Black	NOT USED	-	-
36	Yellow/Black	NOT USED	-	-
37	Grey/Blue	NOT USED	-	-
38	Pink/Blue	NOT USED	-	-
39	Grey/Red	NOT USED	-	-
40	Pink/Red	NOT USED	-	-
41	Grey/Black	NOT USED	-	-
42	Pink/Black	NOT USED	-	-
43	Blue/Black	Common	-	-
44	Red/Black	Common	-	-

¹⁾ According to DIN 47100

NPTF1 Conduit entry with terminals ²⁾

Clamp no.	Socket	Pilot	Station
C1	Solenoid 1-a	14	1
C2	Solenoid 2-a	14	2
C3	Solenoid 3-a	14	3
C4	Solenoid 4-a	14	4
C5	Solenoid 5-a	14	5
C6	Solenoid 6-a	14	6
C7	Solenoid 7-a	14	7
C8	Solenoid 8-a	14	8
C9	Solenoid 9-a	14	9
C10	Solenoid 10-a	14	10
C11	Solenoid 11-a	14	11
C12	Solenoid 12-a	14	12
C13	Solenoid 1-b	12	1
C14	Solenoid 2-b	12	2
C15	Solenoid 3-b	12	3
C16	Solenoid 4-b	12	4
C17	Solenoid 5-b	12	5
C18	Solenoid 6-b	12	6
C19	Solenoid 7-b	12	7
C20	Solenoid 8-b	12	8
C21	Solenoid 9-b	12	9
C22	Solenoid 10-b	12	10
C23	Solenoid 11-b	12	11
C24	Solenoid 12-b	12	12
C25	Common	-	-
C26	Common	-	-
C27	Earth	-	-
C28	Earth	-	-

²⁾ Max. wire size AWG18



Fieldbus options: Overview

Fieldbus protocol	Fieldbus interface/connector	Supply voltage connector (Fieldbus and valves)	No. of stations	Max. no. coils
Profibus DP	1 x D-Sub 9-pin	M12 4-pin	04/05/06/07/08/09/10/11/12/13/14/15/16	32
	2 x M12 5-pin	M12 4-pin	04/05/06/07/08/09/10/11/12/13/14/15/16	32
	2 x M12 5-pin	7/8 5-pin	04/05/06/07/08/09/10/11/12/13/14/15/16	32
Interbus-S	2 x D-Sub 9-pin	M12 4-pin	04/05/06/07/08/09/10/11/12/13/14/15/16	32
AS-Interface - Single slave	1 x M12 4-pin	M12 4-pin	02/03/04	4
AS-Interface - Double slave	1 x M12 4-pin	M12 4-pin	04/05/06/07/08	8
DeviceNet	1 x M12 5-pin	M12 4-pin	04/05/06/07/08/09/10/11/12/13/14/15/16	32
CANopen	1 x M12 5-pin	M12 4-pin	04/05/06/07/08/09/10/11/12/13/14/15/16	32
AB RIO	2 x M12 5-pin	M12 4-pin	04/05/06/07/08/09/10/11/12/13/14/15/16	32

For parts and assembly instructions of Fieldbus components, consult our technical service.

Fieldbus protocol: Profibus DP

Connector: 1 x D-Sub 9-pin / M12 4-pin

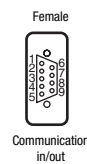
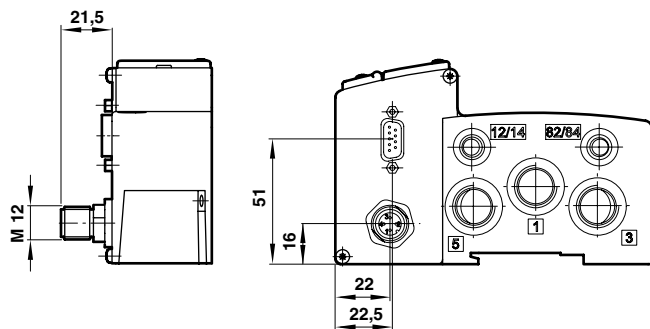

Bus connector: D-Sub 9-pin

Pin no.	Function
1	Shield
2	N/C
3	B-line (red) RxD / TxD-P
4	N/C
5	DGND (OVI) isolated
6	VP (5VI) isolated
7	N/C
8	A-line (green) RxD / TxD-N
9	N/C



Power connector: M12 4-pin

Pin no.	Function	Tolerance	Max. current
1	24 VB logic circuit supply	+/-25%	300 mA
2	24 VA valves	+/-10	1)
3	0 volts	-	2)
4	Earth	-	-

Connector: 2 x M12 5-pin / M12 4-pin

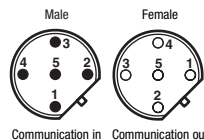
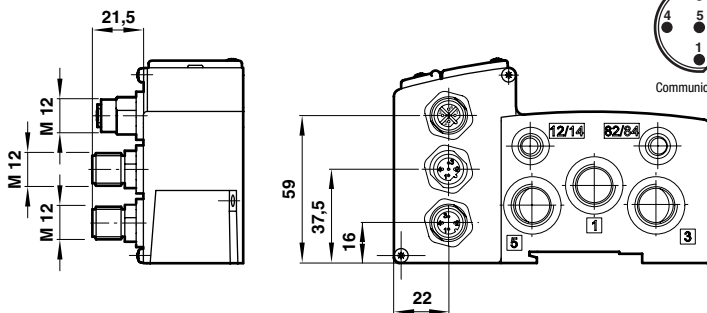

Bus connector: M12 5-pin (B-coded)

Pin no.	Function
1	5VI isolated
2	A-line (green)
3	OVI isolated
4	B-line (red)
5	Shield

Threaded joint Shield



Power connector: M12 4-pin

Pin no.	Function	Tolerance	Max. current
1	24 VB logic circuit supply	+/-25%	300 mA
2	24 VA valves	+/-10	1)
3	0 volts	-	2)
4	Earth	-	-

Connector: 2 x M12 5-pin / 7/8 5-pin

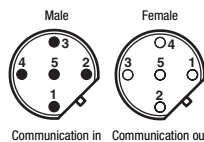
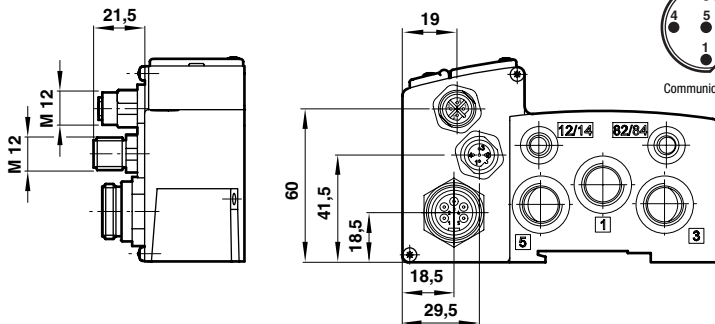

Bus connector: M12 5-pin (B-coded)

Pin no.	Function
1	5VI isolated
2	A-line (green)
3	OVI isolated
4	B-line (red)
5	Shield

Threaded joint Shield

Power connector: 7/8 5-pin

Pin no.	Function	Tolerance	Max. current
1	-	-	-
2	0 volts	-	2)
3	Earth	-	-
4	24 VA valves	+/-10%	1)
5	24 VB logic circuit supply	+/-25%	300 mA

1) $I_{max} = 10 \text{ mA} + n \cdot 60 \text{ mA}$
 $n = \text{number of energized solenoids}$

2) $I_{max} = I_{VA} + I_{VB}$



Fieldbus protocol: Interbus-S

Connector: 2 x D-Sub 9-pin / M12 4-pin

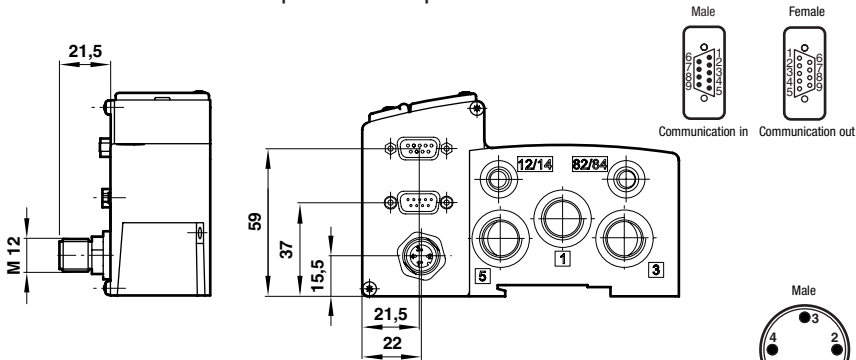

Bus connector: D-Sub 9-pin

Pin no.	Function Male	Function Female
1	DO	DO
2	DI	DI
3	OVI	OVI
4	-	-
5	-	+5VI
6	/DO	/DO
7	/DI	/DI
8	-	-
9	-	RBST

Power connector: M12 4-pin

Pin no.	Function	Tolerance	Max. current
1	24 VB logic circuit supply	+/-25%	300 mA
2	24 VA valves	+/-10	¹⁾
3	0 volts	-	²⁾
4	Earth	-	-

Fieldbus protocol: AS-Interface

Connector: 1 x M12 / M12 4-pin

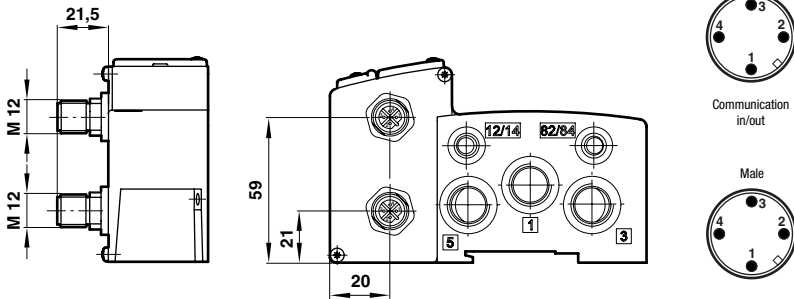

Bus connector: M12 4-pin

Pin no.	Function	Max. current
1	AS-I	³⁾
2	-	-
3	AS-I	-
4	-	-

Power connector: M12 4-pin

Pin no.	Function	Tolerance	Max. current
1	+24 V DC	+/-10%	⁴⁾
2	-	-	-
3	0 volts	-	-
4	-	-	-

¹⁾ $I_{max} = 10 \text{ mA} + n \cdot 60 \text{ mA}$
n = number of energized solenoids

²⁾ $I_{max} = I_{VA} + I_{VB}$

³⁾ Single slave: 40 mA
Double slave: 75 mA

⁴⁾ Single slave:
 $I_{max} = 20 \text{ mA} + n \cdot 60 \text{ mA}$
Double slave:
 $I_{max} = 35 \text{ mA} + n \cdot 60 \text{ mA}$
n = number of energized solenoids



Fieldbus protocol: DeviceNet

Connector: 1 x M12 5-pin / M12 4-pin

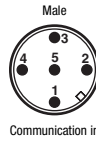
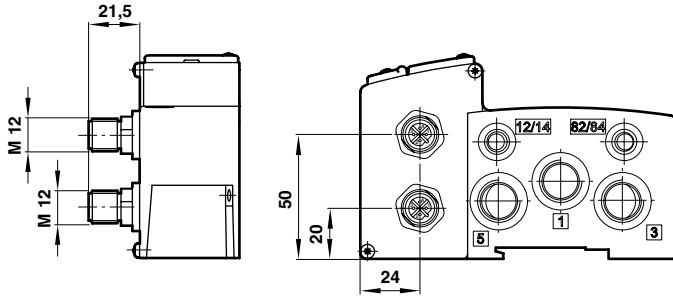

Bus connector: M12 5-pin (A-coded)

Pin no.	Function
1	Drain
2	V+
3	V-
4	CAN_H
5	CAN_L



Power connector: M12 4-pin

Pin no.	Function	Tolerance	Max. current
1	24 VB logic circuit supply	+/-25%	300 mA
2	24 VA valves	+/-10	1)
3	0 volts	-	2)
4	Earth	-	-

Fieldbus protocol: CANopen

Connector: 1 x M12 5-pin / M12 4-pin

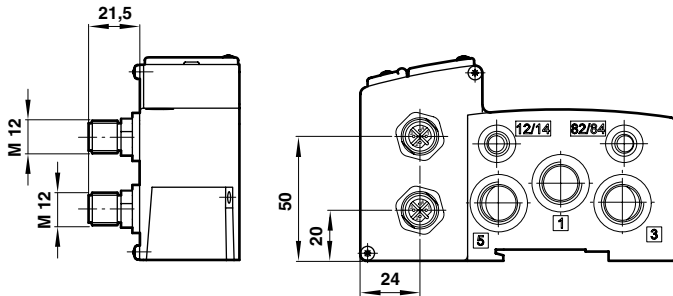

Bus connector: M12 5-pin (A-coded)

Pin no.	Function
1	Drain
2	V+
3	V-
4	CAN_H
5	CAN_L

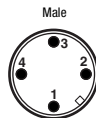

Power connector: M12 4-pin

Pin no.	Function	Tolerance	Max. current
1	24 VB logic circuit supply	+/-25%	300 mA
2	24 VA valves	+/-10	1)
3	0 volts	-	2)
4	Earth	-	-

Fieldbus protocol: AB RIO

Connector: 2 x M12 5-pin / M12 5-pin

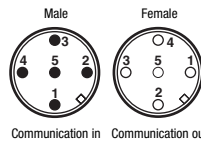
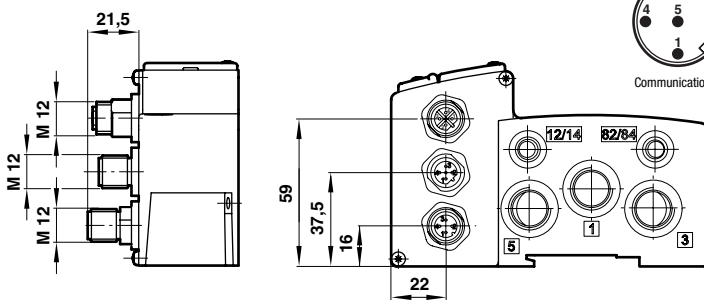

Bus connector: M12 5-pin (A-coded)

Pin no.	Function
1	RIO 1
2	-
3	RIO 2
4	-
5	RIO SH

Power connector: M12 4-pin

Pin no.	Function	Tolerance	Max. current
1	24 VB logic circuit supply	+/-25%	300 mA
2	24 VA valves	+/-10	1)
3	0 volts	-	2)
4	Earth	-	-

1) $I_{max} = 10 \text{ mA} + n \cdot 60 \text{ mA}$
 $n = \text{number of energized solenoids}$

2) $I_{max} = I_{VA} + I_{VB}$



Fieldbus accessories

Symbol	Model	Description	Connection	Cable length	Protection class
	V11588-E01	Profibus DP (4-pin, female) Interbus-S (4-pin, female) DeviceNet (4-pin, female) CANopen (4-pin, female) AB RIO (4-pin, female)	M12	Wireable	IP65 Required for ATEX
	VS2672907-KG00	Profibus DP (5-pin, female)	7/8	Wireable	IP65 Required for ATEX
Communication cable and connector					
	V11589-E01	DeviceNet (5-pin, female) CANopen (5-pin, female) AB RIO (5-pin, female)	M12	Wireable	IP65 Required for ATEX
	VE1FBCRS-M125P	AB RIO (5-pin, male)	M12	Wireable	IP65 Required for ATEX
	V11590-E01	Profibus DP, reverse keyway (5-pin, male)	M12	Wireable	IP65 Required for ATEX
	V11591-E01	Profibus DP, reverse keyway (5-pin, female)	M12	Wireable	IP65 Required for ATEX
	V11654-E01	Profibus DP connector (9-pin, male) with terminating resistor	D-Sub	Wireable	IP40
	V11592-E01	Profibus DP terminating resistor (male)	M12	-	IP65 Required for ATEX
	VE1ASCN1-M1200	AS-Interface power or communications (4-pin, female)	M12	Wireable	IP65 Required for ATEX
	VE2FBC9P-9S010	Interbus-S (9-pin)	D-Sub	1m	IP65 Required for ATEX
	VE2FBC9P-9S030			3m	
	VE2FBC9P-9S050			5m	
	VE2FBC9P-00000	Interbus-S (9-pin, male)	D-Sub	Wireable	IP65 Required for ATEX
	VE2FBC9S-00000	Interbus-S (9-pin, female)	D-Sub	Wireable	IP65 Required for ATEX
	V11340-E03	Interbus-S terminating connector (9-pin, female)	D-Sub	-	IP65 Required for ATEX

Worksheet VS26 Series (Please mark the corresponding boxes and fax the sheet to Norgren customer service)



Part no of configured valve island:
 VS26 ____-____-____-____-____-____
 (This line will be filled out by Norgren)
 In case of repeat order, please indicate only this number.

Valves	Station																	
	G	S	1	2	3	4	5	6	7	8	9	10	11	12	13	14	15	16
2 x 3/2 Sol/Spring NC		X																
2 x 3/2 Sol/Spring NO (5/3 COP)		X																
2 x 3/2 Sol/Spring NO/NC		X																
5/2 Sol/Spring																		
5/2 Sol/Sol																		
5/2 Sol priority side 14/Sol		X																
5/3 APB Sol/Sol																		
5/3 COE Sol/Sol																		
Base accessories (optional)	Intermediate supply/exhaust module G1/4																	
	Intermediate supply/exhaust module NPTF1/4																	
	Blanking plate																	
Sandwich plates (optional)	Pressure regulator, port 1																	
	Pressure regulator, port 2																	
	Pressure regulator, port 4																	
	Pressure regulator, port 2+4																	
	Flow regulator, port 3 + 5																	
	Single valve shut-off plate, port 1																	
Outlet port size in sub-base	G1/4																	
	NPTF1/4																	
	PIF10 mm																	
	PIF8 mm																	
	PIF3/8																	
Blanking discs ¹⁾ (optional)	Port 1																	
	Port 3 + 5																	
	Port 1 + 3 + 5																	

¹⁾ For blanking discs after odd valve stations please contact technical service

Pilot supply

- Internal
 - External
 - Mixed (please specify in notes)
- ATEX approval (24V DC)**
- Yes (requires use of approved VS26 connectors)

Manual override (all valves)

- Push only
- Push & turn
- Extended, push only
- Mixed (please specify in notes)

End plate kit

- G3/8
- NPTF3/8

Multipole connectors (voltage)

- 9-pin D-Sub (24V DC)
 - 15-pin D-Sub (24V DC)
 - 25-pin D-Sub (24V DC)
 - 44-pin D-Sub (24V DC)
 - NPTF1 Conduit entry (24V DC and 115V AC)
- Fieldbus options (24V DC)**
- Profibus DP: 1 x D-Sub 9-pin / M12 4-pin
 - Profibus DP: 2 x M12 5-pin / M12 4-pin
 - Profibus DP: 2 x M12 5-pin / 7/8 5-pin
 - Interbus-S: 2 x D-Sub 9-pin / M12 4-pin
 - AS-Interface: 1 x M12 4-pin / M12 4-pin
 - DeviceNet: 1 x M12 5-pin / M12 4-pin
 - CANopen: 1 x M12 5-pin / M12 4-pin
 - AB RIO: 2 x M12 5-pin / M12 4-pin

Multipole connectors (voltage)

- Connector with cable 1m
- Connector with cable 3m
- Connector with cable 5m

Accessories

- DIN-rail 1m (35 x 7.5mm)
- DIN-rail 1m (35 x 15mm)
- DIN-rail mounting kit (1 per valve island)
- Manual override set-up kit: quantity _____

Additional accessories / Notes:



A – Single add-on stations

including PCB, sub-base, gasket and screws

Model	Description	Ports 2 & 4
VS2672504-BGF0	Add-on station for D-Sub connectors and Fieldbus	G1/4
VS2672504-RGF0	Add-on station for D-Sub connectors and Fieldbus	NPTF1/4
VS2672504-YGF0	Add-on station for D-Sub connectors and Fieldbus	PIF10 mm
VS2672504-8GF0	Add-on station for D-Sub connectors and Fieldbus	PIF8 mm
VS2672504-2GF0	Add-on station for D-Sub connectors and Fieldbus	PIF3/8
VS2672505-BGF0	Add-on station for Conduit entry	G1/4
VS2672505-RGF0	Add-on station for Conduit entry	NPTF1/4
VS2672505-YGF0	Add-on station for Conduit entry	PIF10 mm
VS2672505-8GF0	Add-on station for Conduit entry	PIF8 mm
VS2672505-2GF0	Add-on station for Conduit entry	PIF3/8

Valves and accessories to be ordered separately (see pages 2-12)

Step 1

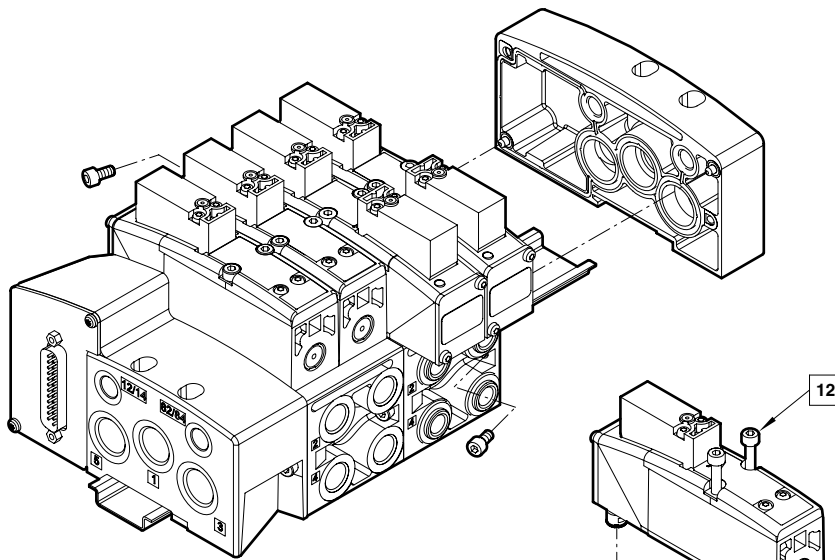

Step 2

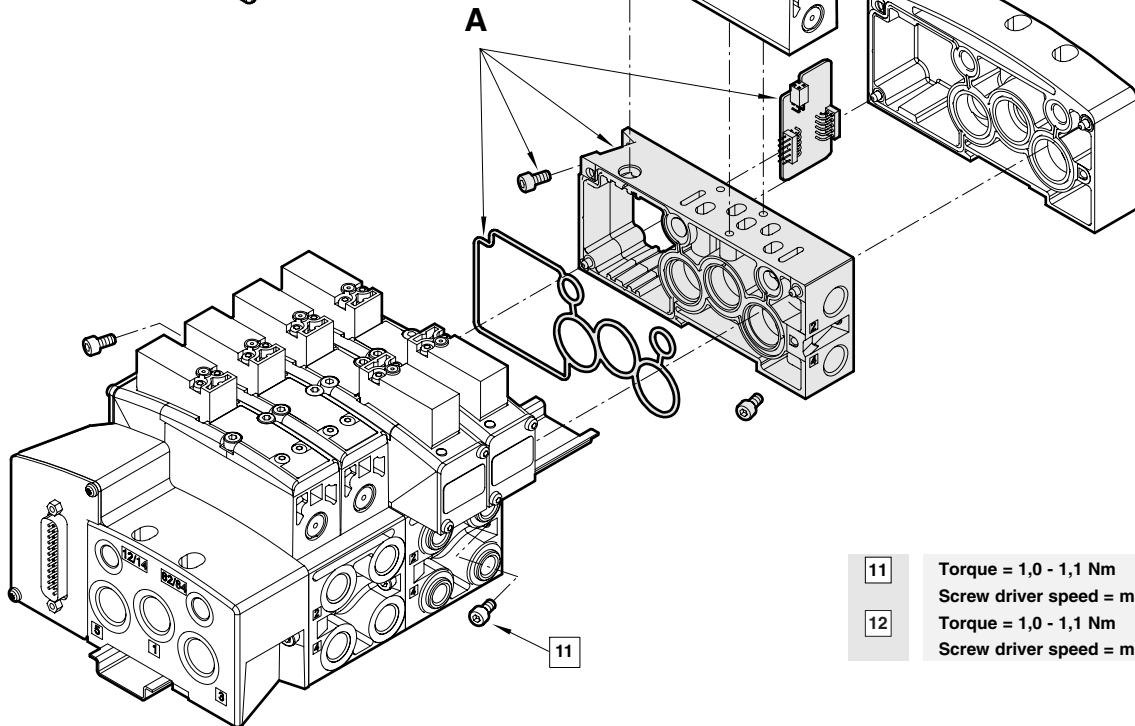

- 11** Torque = 1,0 - 1,1 Nm
Screw driver speed = max. 1100 r.p.m.
- 12** Torque = 1,0 - 1,1 Nm
Screw driver speed = max. 1100 r.p.m.

For detailed assembly instructions, please see maintenance & instruction booklet!



Sub-bases and end plates (without PCB's)
including screws and gaskets

A – End plate kit

Model	Description	Ports 1, 3 & 5	Ports 12/14 & 82/84
VS2672500-CGCO	End plate kit for Multipole	G3/8	G1/8
VS2672500-SGCO	End plate kit for Multipole	NPTF3/8	NPTF1/8
VS2672501-CGCO	End plate kit for Fieldbus	G3/8	G1/8
VS2672501-SGCO	End plate kit for Fieldbus	NPTF3/8	NPTF1/8

B – Double station modular sub-base

Model	Ports 2 & 4
VS2672502-BGFO	G1/4
VS2672502-RGFO	NPTF1/4
VS2672502-YGFO	PIF10 mm
VS2672502-8GFO	PIF8 mm
VS2672502-2GFO	PIF3/8

For Multipole PCB's see pages 24-25

C – Single station modular sub-base

Model	Ports 2 & 4
VS2672503-BGFO	G1/4
VS2672503-RGFO	NPTF1/4
VS2672503-YGFO	PIF10 mm
VS2672503-8GFO	PIF8 mm
VS2672503-2GFO	PIF3/8

For Multipole PCB's see pages 24-25

Spare parts

Model	Description	Quantity per slice
77.31106	Hexagon socket screw M4x12	2
94.00815	Gasket	1
94.00816	Connector-kit gasket on end plate	1

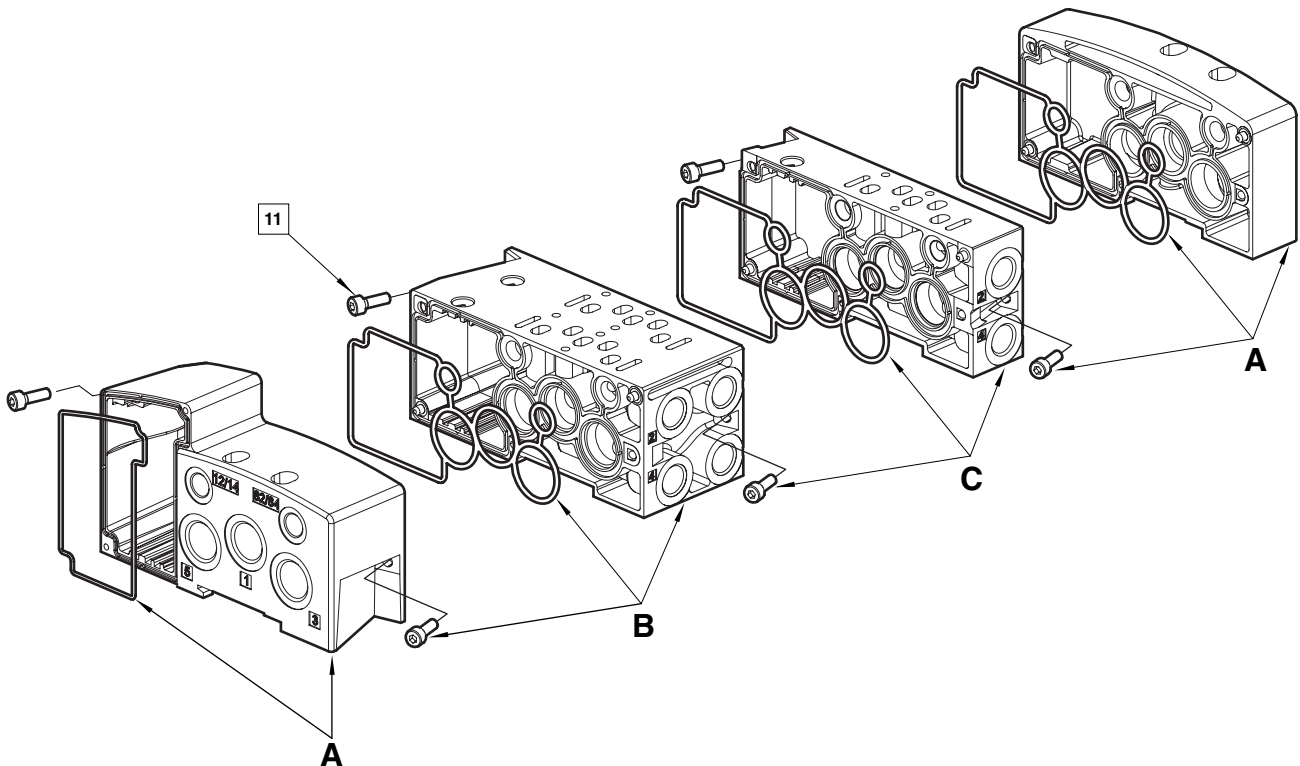

For detailed assembly instructions, please see maintenance & instruction booklet!

11 Torque = 1,0 - 1,1 Nm
Screw driver speed = max. 1100 r.p.m.



Multipole components

A – Output boards with D-Sub connectors

Model	Connector type	Description	Expandable to max. x no. of stations ¹⁾	Voltage
VS2672717-KG00	D-Sub 9-pin	Multipole PCB 2 stations	4	24V DC
VS2672718-KG00	D-Sub 15-pin	Multipole PCB 2 stations	6	24V DC
VS2672705-KG00	D-Sub 15-pin	Multipole PCB 4 stations	7	24V DC
VS2672719-KG00	D-Sub 25-pin	Multipole PCB 2 stations	6	24V DC
VS2672700-KG00	D-Sub 25-pin	Multipole PCB 4 stations	8	24V DC
VS2672701-KG00	D-Sub 25-pin	Multipole PCB 6 stations	10	24V DC
VS2672702-KG00	D-Sub 25-pin	Multipole PCB 8 stations	12	24V DC
VS2672703-KG00	D-Sub 44-pin	Multipole PCB 8 stations	12	24V DC
VS2672706-KG00	D-Sub 44-pin	Multipole PCB 10 stations	14	24V DC
VS2672704-KG00	D-Sub 44-pin	Multipole PCB 12 stations	16	24V DC

¹⁾ By using below expansion output boards.

Expansion output boards for D-Sub connectors

Model	Description	Voltage
VS2672755-KG00	Multipole PCB 1 station	24V DC
VS2672713-KG00	Multipole PCB 2 stations	24V DC

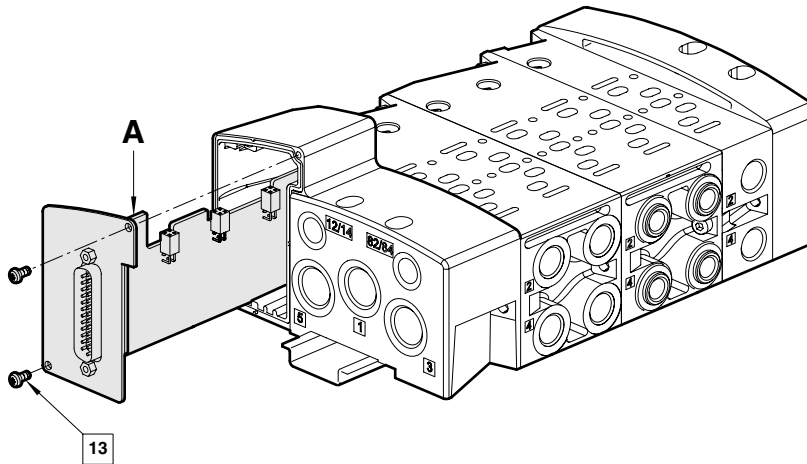

For detailed assembly instructions, please see maintenance & instruction booklet!

13

Torque = 0,8 - 0,9 Nm
Screw driver speed = max. 1100 r.p.m



Multipole components

A – Connector-kit for conduit entry

Model	Description	Voltage
VS2672742-KG00	E-Connector-kit NPTF1 Conduit entry	115V AC, 24V DC

B – Output boards for conduit entry

Model	Description	Expandable to max. x no. of stations ¹⁾	Voltage
VS2672708-KG00	Multipole PCB 2 stations	6	115V AC, 24V DC
VS2672709-KG00	Multipole PCB 4 stations	8	115V AC, 24V DC
VS2672710-KG00	Multipole PCB 6 stations	10	115V AC, 24V DC
VS2672711-KG00	Multipole PCB 8 stations	12	115V AC, 24V DC

¹⁾ By using below expansion output boards.

Expansion output boards for conduit entry

Model	Description	Voltage
VS2672756-KG00	Multipole PCB 1 station	115V AC, 24V DC
VS2672715-KG00	Multipole PCB 2 stations	115V AC, 24V DC

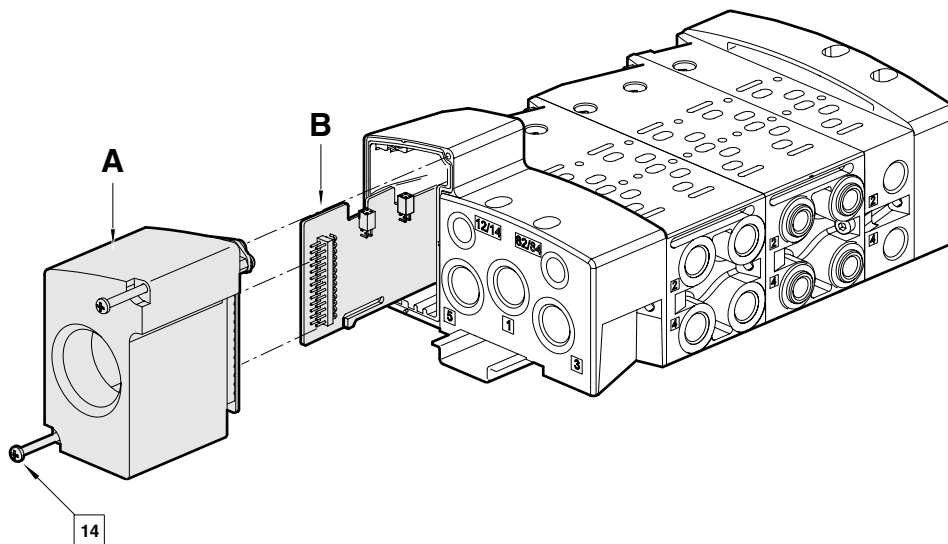

For detailed assembly instructions, please see maintenance & instruction booklet!

14

Torque = 0,8 - 0,9 Nm
Screw driver speed = max. 1100 r.p.m